



*Research Department*

**OPEN DAY**

***Exhibits & Demonstrations***

*July 1990*

July 1990

**MANSION**

**GROUND FLOOR**

- A4 Euroradio**  
Satellite broadcasting reception and planning
- A5 Television Outside Broadcast Systems**  
HF transmitting antennas  
AM Companding for HF transmitters  
Computer software for electromagnetic problems

**Listening Rooms**

- LR1 Dynamic audio compression**
- LR2 Live loudspeaker demonstrations**
- ATR Digital Audio Editing**

**Free Field Room (FFR)**

- Loudspeaker and microphone testing
- Loudspeaker exhibit
- Microphones through the ages

**SECOND FLOOR**

- A204 Radio Teleswitching**
- A209 RDS**
- A212 NICAM 728**

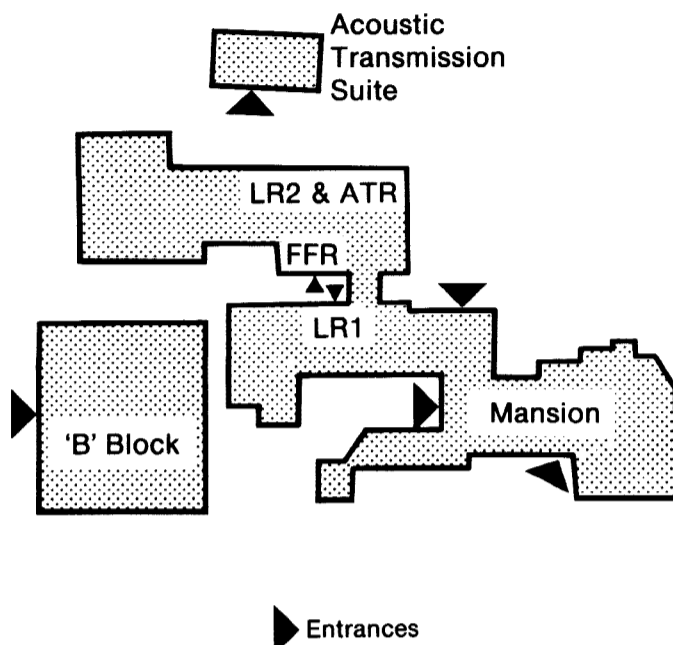

**'B' BLOCK**

- Large Viewing Room**  
High Definition Television (HDTV)
- B1 (Studio)**  
Mass HDTV store display
- B17 Optical routing**
- B20 Computer Aided Design (CAD) and Workshop display**
- B21 Low bit-rate television**

**Acoustic Transmission Suite**

- Acoustic testing of structures
- Diving helmet demonstration

60<sup>th</sup>

ANNIVERSARY

- A Hot air balloon with radio-linked camera**
- B Helitrak system receiving pictures from balloon**  
Antenna radiation pattern measurement
- C Turntable for radiation pattern measurement**
- D Service Planning marquee**
- E Service Planning television and radio survey vehicles**
- F Service Planning television and radio site-test transmitters**
- G Service Planning UHF antenna calibration**
- H HF receiving antennas**
- I Radio-camera**
- J Camera car**
- K Antennas for satellite reception**
- L Transportable satellite earth station**
- M Engineering Information Department tuning clinic**
- N High Definition Television production unit**
- O Elevated camera platform**
- P Television Outside Broadcast vehicle**
- Q Helitele camera**
- R History of Research Department**  
Manchester Studio acoustic model  
Research Department Library
- S RDS demonstration vehicle**

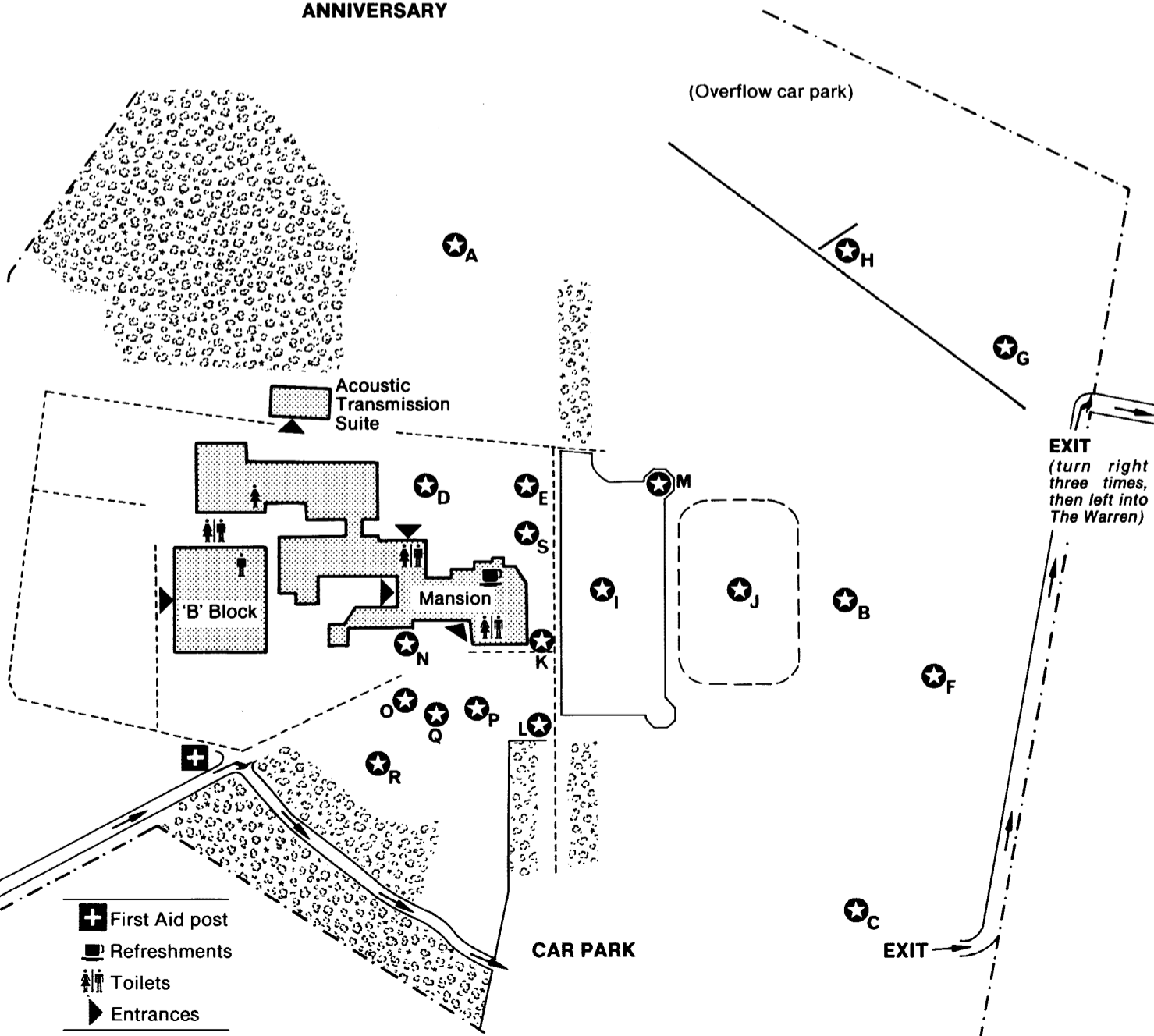

**MAIN ENTRANCE**  
The Warren  
(from A217)

- +** First Aid post
- ☐** Refreshments
- ♿** Toilets
- ▶** Entrances

**CAR PARK**

**EXIT**

**60<sup>th</sup>**

**ANNIVERSARY  
YEAR**

1930

1990